

Description

- Feedthrough capacitors offer a high insertion loss across a broad band of frequencies from a few tens of kHz up to the GHz region.
- Very low internal series inductance.
- Very high self-resonant frequency.
- Self-healing dielectric.
- High quality and reliability.
- Through-bulkhead mounting.
- Anti-twist protection.
- Custom-specific or dual-versions on request.

Electrical Schematic:

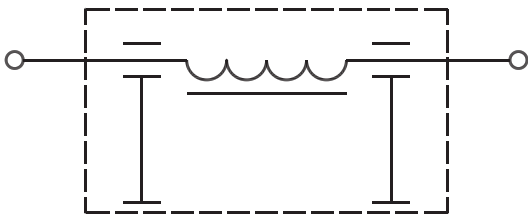

Fig 1

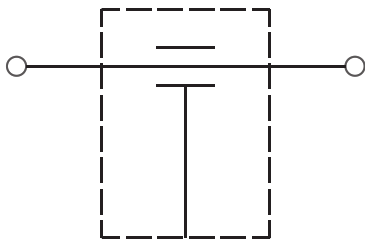

Fig 2

Typical Applications :

- AC Power line filter for 250VAC power lines
- DC Power line filter for 48VDC battery power
- Increasing system and information security
- Power supplies
- Switching and cellular equipment
- Computer servers
- UPS power supplies
- Medical equipment
- Shielded rooms

Specification :

Rated Voltage: 250VAC@50/60Hz

80VDC-600VDC

Rated Current: 1A~250A

Temperature range : HPF 40/085/56

Data table:

MCT P/N:	Rated Current: A	Rated Voltage: V	Leakage Current: mA	Capacitance: uF	Electrical Schematic:	Test Voltage 1 min VDC
MCT9FE-16-M4	16	250	4.13	2×0.022	1	2250
MCT9FE-63-M6	63	250	88.7	2×0.47	1	2250
MCT9FE-100-M8	100	250	565	2×3.0	1	2120
MCT91FE-100-M8	100	250	565	2×3.0	1	2200
MCT9FE-250-M12	250	250	158	2×1.0	1	2250
MCT91FE-30-M5	30	600	-	2×0.018	1	2500
MCT91FE-50-M6	50	200	-	0.22	2	720
MCT9FE-65-M6	65	200	-	2×4.7	1	1000
MCT91FE-65-M6	65	250	-	2×0.25	1	2250
MCT92FE-65-M6	65	250	-	2×0.22	1	2250
MCT9FE-230-M10	230	400	-	2×3.3	1	2121
MCT9FE-250-M10	250	200	-	1.68	2	1500

Dimension: unit :mm

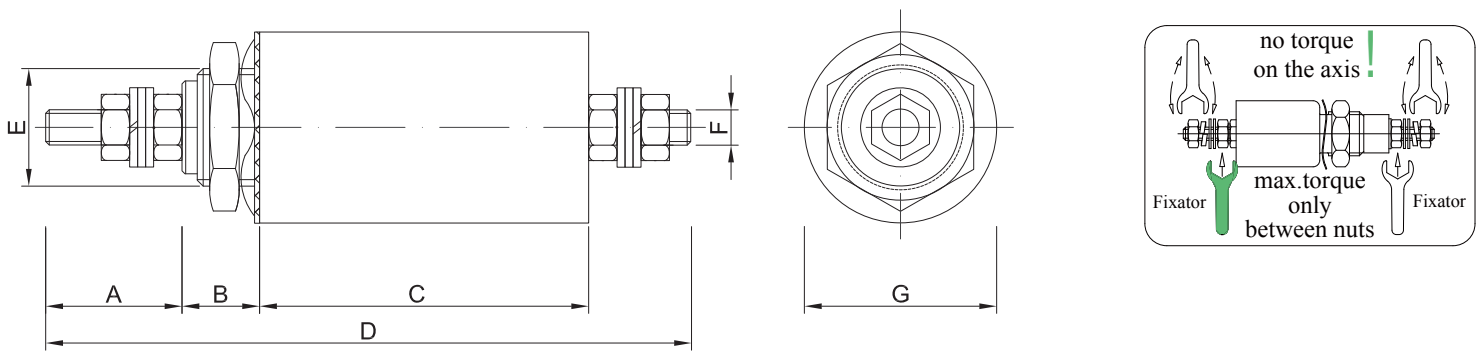

Fig 21

MCT P\N:	A	B	C	D	E	F	G
MCT9FE-16-M4	20	18	54	110	M20×1	M4	Φ42
MCT9FE-63-M6	26	18	83	148	M30×1.5	M6	Φ50
MCT9FE-100-M8	34	18	83	160	M30×1.5	M8	Φ50
MCT91FE-100-M8	34	15	86	160	M24×1	M8	Φ45
MCT9FE-250-M12	41	16	96	190	M32×1.5	M12	Φ55
MCT91FE-30-M5	24.5	11	45	100	M12×1	M5	Φ20
MCT91FE-50-M6	16	6	21.5	64	M16×1	M6	Φ19
MCT9FE-65-M6	20	10	141	195	M20×1	M6	Φ39
MCT91FE-65-M6	19.5	7	52	100	M16×1	M6	Φ25
MCT92FE-65-M6	19.5	7	44	87.6	M16×1	M6	Φ25
MCT9FE-230-M10	31	16	89	168	M32×1.5	M10	Φ52
MCT9FE-250-M10	32	5	30	88	Φ17	M10	Φ35

Recommended torque:

FILTER	M3	M4	M6	M8	M10	M10×1	M12×1	M16×1	M20×1	M24×1	M27×1.5
Terminal thread	0.5Nm	1.2Nm	2.5Nm	5Nm	8Nm						
Mounting thread						2Nm	3Nm	4Nm	7Nm	8Nm	12Nm

Insertion Loss in dB:

(Measured in 50Ω system , as IEC/CISPR NO.17)

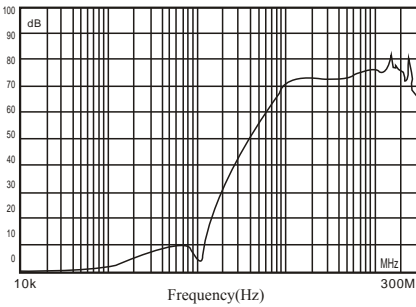

MCT9FE-16-M4

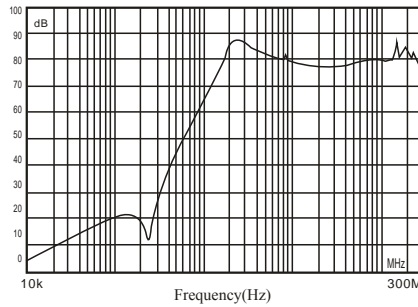

MCT9FE-63-M6

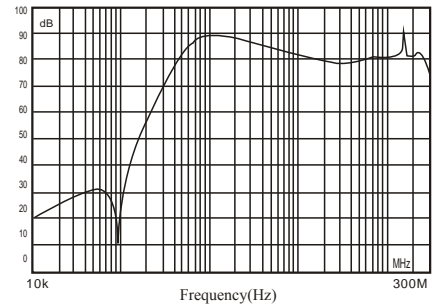

MCT9FE-100-M8

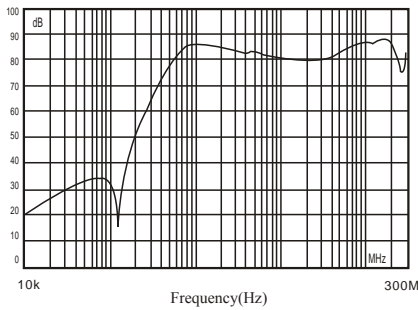

MCT91FE-100-M8

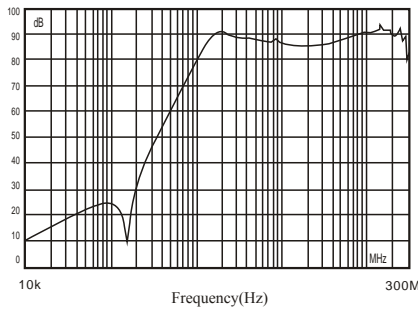

MCT9FE-250-M12

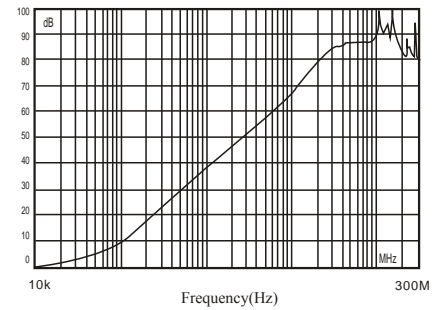

MCT91FE-30-M5

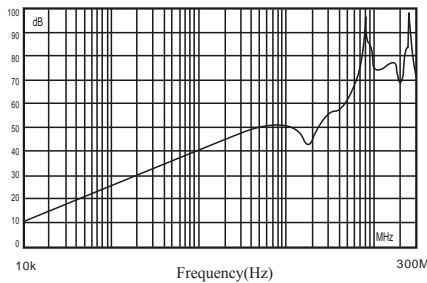

MCT91FE-50-M6

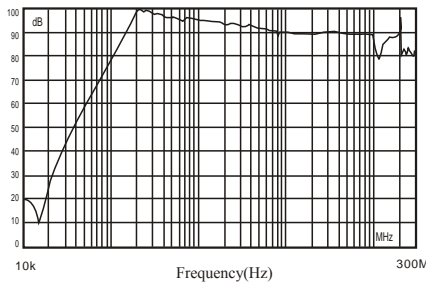

MCT9FE-65-M6

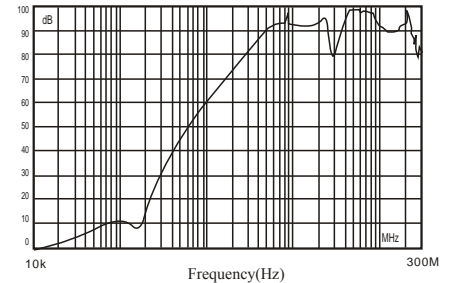

MCT91FE-65-M6

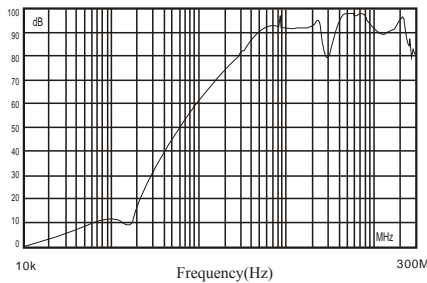

MCT92FE-65-M6

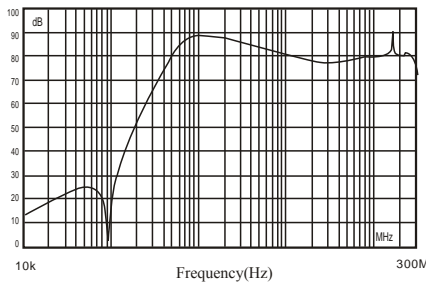

MCT9FE-230-M10

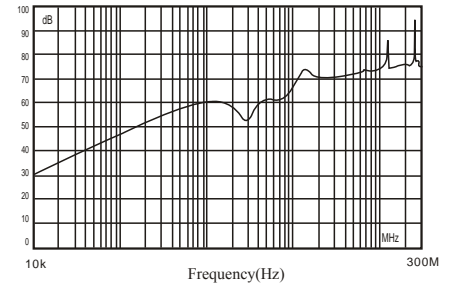

MCT9FE-250-M10