

FEATURES:

- Ferrite core with UL tube
- Wire wound construction
- High current, low DCR

APPLICATIONS:

- Electronic Appliance

- Power Supplies
- TRIAC/SCR Control Circuits

STANDARD SPECIFICATIONS

- Storage Temperature: -25°C ~ +125°C
- Operating Temperature: -25°C ~ +85°C

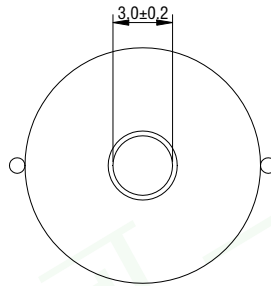
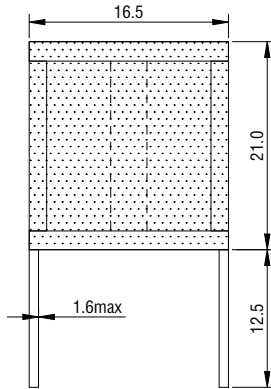
OUTLINE DRAWING:

We offer these dimension Larger Drum core inductor:

Core Size	Out diameter	Hole diameter	Hight	Core Size	Out diameter	Hole diameter	Hight
65×43×35	65	35	43	28×23×18	28	18	23
65×38×35	65	35	38	28×25×14	28	14	25
56×55×33	56	33	55	26×25×14	26	14	25
50×30×21	50	21	30	26×20×14	26	14	20
45×35×28	45	28	35	25×25×14	25	14	25
40×30×25	40	25	30	25×22×14	25	14	22
40×30×21	40	21	30	25×15×14	25	14	15
40×37×18	40	18	37	23×18×13	23	13	18
40×35×21	40	21	35	22×35×13	22	13	35
40×30×18	40	18	30	22×25×13	22	13	25
40×25×18	40	18	25	22×21×13	22	13	21
35×25×21	35	21	25	22×20×13	22	13	20
35×28×21	35	21	28	22×18×13	22	13	18
35×35×18	35	18	35	22×18×11	22	11	18
30×25×15	30	15	25	22×14×13	22	13	14
30×25×14	30	14	25	22×14×11	22	11	14
30×20×15	30	15	20	20×20×13	20	13	20
30×20×14	30	14	20	20×20×11	20	11	20
28×28×18	28	18	28	20×14×13	20	13	14
28×25×18	28	18	25	20×14×11	20	11	14

DATA TABLE::

Part Number	Inductance	Tolerance	DCR (Max)	Saturation Current (Max)	Temperature Rise Current (Max)
Units	μH	%	Ω	A	A
Symbol	L	K,M	DCR	Isat	Irms
MCTBD-01-1R0	1.0	K,M	0.003	87.0	9.0
MCTBD-01-1R2	1.2	K,M	0.003	68.0	9.0
MCTBD-01-1R5	1.5	K,M	0.004	56.0	9.0
MCTBD-01-1R8	1.8	K,M	0.004	56.0	9.0
MCTBD-01-2R2	2.2	K,M	0.005	47.0	9.0
MCTBD-01-2R7	2.7	K,M	0.005	47.0	9.0
MCTBD-01-3R3	3.3	K,M	0.005	40.0	9.0
MCTBD-01-3R9	3.9	K,M	0.006	36.0	9.0
MCTBD-01-4R7	4.7	K,M	0.007	32.0	9.0
MCTBD-01-5R6	5.6	K,M	0.007	29.0	9.0
MCTBD-01-6R8	6.8	K,M	0.008	26.0	9.0
MCTBD-01-8R2	8.2	K,M	0.009	24.5	9.0
MCTBD-01-100	10	K	0.010	21.2	9.0
MCTBD-01-120	12	K	0.011	19.0	9.0
MCTBD-01-150	15	K	0.015	17.5	7.2
MCTBD-01-180	18	K	0.016	16.5	7.2
MCTBD-01-220	22	K	0.025	15.8	5.5
MCTBD-01-270	27	K	0.030	14.4	4.5
MCTBD-01-330	33	K	0.040	13.2	4.0
MCTBD-01-390	39	K	0.046	11.8	4.0
MCTBD-01-420	42	K	0.050	11.3	3.8
MCTBD-01-470	47	K	0.062	11.0	2.8
MCTBD-01-560	56	K	0.069	10.0	2.8
MCTBD-01-680	68	K	0.077	8.9	2.8
MCTBD-01-820	82	K	0.083	8.2	2.8
MCTBD-01-101	100	K	0.095	7.5	2.8
MCTBD-01-121	120	K	0.127	5.8	2.0
MCTBD-01-151	150	K	0.181	5.6	1.6
MCTBD-01-181	180	K	0.217	5.1	1.6
MCTBD-01-221	220	K	0.240	4.3	1.6
MCTBD-01-271	270	K	0.300	4.1	1.6
MCTBD-01-331	330	K	0.336	3.8	1.3
MCTBD-01-391	390	K	0.460	3.3	1.0
MCTBD-01-471	470	K	0.636	3.2	0.8
MCTBD-01-561	560	K	0.696	2.9	0.8
MCTBD-01-681	680	K	0.700	2.9	0.8